

CONDITIONAL USE REQUIREMENT 370-2104	PROPOSED
THE FACILITY IS CONNECTED BOTH TO PUBLIC WATER AND PUBLIC SEWER SYSTEMS AND THAT ALL SERVICES ARE CONDUCTED WITHIN THE CONFINES OF THE LOT.	PUBLIC WATER AND PUBLIC SEWER SYSTEMS ARE LOCATED WITHIN KANSAS ROAD AND ARE CONDUCTED WITHIN THE CONFINES OF THE LOT.
NO ENTRANCE OR EXIT SHALL BE LOCATED WITHIN 100 FT OF A PROPERTY OF A SCHOOL, HOUSE OF WORSHIP OR HOSPITAL.	NO SCHOOL, HOUSE OF WORSHIP OR HOSPITAL IS LOCATED WITHIN 100 FT OF THE PROPERTY LINE.
NO MOTOR FUEL OR FUELING PUMP SHALL BE INSTALLED WITHIN 50 FT OF AN ABUTTING STREET LINE.	EACH FUEL HOSE IS SETBACK MORE THAN 50 FT FROM A STREET LINE.
ALL ACTIVITIES OTHER THAN THE SALE OF GASOLINE, OIL, ANTI-FREEZE AND TIRES MUST BE CONDUCTED IN THE BUILDING ON THE PREMISES.	ONLY GASOLINE SALES WILL BE CONDUCTED OUTSIDE THE PREMISE OF THE CONVENIENCE STORE.
NO VEHICLE MAY BE PARKED EXCEPT SUBJECT TO THE RESTRICTIONS SET FORTH IN THE OFF-STREET PARKING REGULATIONS, ARTICLE XXXIV.	OFF-STREET PARKING COMPLIES WITH ARTICLE XXXIV.
THERE SHALL BE A MINIMUM LOT WIDTH OF 200 FT AT THE ULTIMATE RIGHT-OF-WAY.	THERE IS A MINIMUM LOT WIDTH OF 200 FT AT THE ULTIMATE RIGHT-OF-WAY.
PAINT SPRAYING OR BODY AND FENDER WORK SHALL NOT BE PERMITTED.	PAINT SPRAYING OR BODY AND FENDER WORK WILL NOT BE CONDUCTED AT THE PROPERTY.
VEHICLES SHALL NOT BE STORED OUTDOORS WHILE AWAITING REPAIRS FOR MORE THAN 30 DAYS; ALL SUCH CARS SHALL BE TOTALLY SCREENED WITH THIS CHAPTER.	VEHICLE REPAIRS AND/OR MAINTENANCE WILL NOT BE CONDUCTED AT THE PROPERTY.
THE SALE OR RENTAL OF AUTOMOBILES SHALL BE PROHIBITED.	THE SALE OR RENTAL OF AUTOMOBILES WILL NOT BE CONDUCTED AT THE PROPERTY.
THE MOTOR VEHICLE SERVICE STATION OR CAR-WASH FACILITY IS LOCATED ON A LOT CONTAINING A MINIMUM OF TWO ACRES.	THE PROPOSED LOT SIZE IS 2.007 ACRES.
THE LOT ON WHICH THE MOTOR VEHICLE SERVICE STATION OR CAR-WASH FACILITY IS LOCATED HAS DIRECT ACCESS TO FOUR-LANE ROADWAY (TWO LANES IN EACH DIRECTION).	THE MOTOR VEHICLE SERVICE STATION HAS DIRECT ACCESS TO EASTON ROAD (S.R. 611), WHICH IS A FOUR-LANE ROADWAY.

THE FOLLOWING VARIANCES WERE GRANTED AS PER THE SETTLEMENT AGREEMENT DATED JANUARY 14, 2020 DOCKET NO. 2019-05878

- A VARIANCE FROM SECTION 27-1106.1 "SCREENING AND BUFFERING".  
TO PERMIT STREET SCREENING/BUFFERING OF 8.5' ALONG A PORTION OF EASTON ROAD RATHER THAN THE REQUIRED 15'.
- VARIANCES FROM SECTION 27-2101.15 "OFF-STREET PARKING, LOADING, AND UNLOADING - GENERAL REGULATIONS".  
TO PERMIT A PARKING SETBACK OF 8.5' FROM THE ULTIMATE RIGHT-OF-WAY OF A PORTION OF EASTON ROAD RATHER THAN THE REQUIRED 15'.  
TO PERMIT A SHARED ACCESS ROAD SETBACK OF 0' FROM THE SHARED PROPERTY LINE RATHER THAN THE REQUIRED 10'.

ZONE: C2 - COMMERCIAL 2

**PROPOSED WAWA**  
EXISTING USE: RETAIL  
PROPOSED USE: MOTOR VEHICLE SERVICE STATION (WAWA)  
PERMITTED USE: MOTOR VEHICLE SERVICE STATION PERMITTED AS CONDITIONAL USE

BULK DESCRIPTION	REQUIRED	EXISTING	WAWA	PROPOSED
MIN. LOT SIZE - SERVICE STATION	2 AC	1,374 AC.	N/A	2,007 AC.
MIN. LOT SIZE - OTHER USES	20,000 SF	N/A	N/A	N/A
MIN. LOT WIDTH	200 FT	381.4 FT EASTON ROAD	381.4 FT EASTON ROAD	63 FT
MIN. FRONT YARD SETBACK (EASTON RD.)	60 FT	62.5 FT	63 FT	63 FT
MIN. FRONT YARD SETBACK (MAPLE AVE.)	60 FT	71.3 FT	130.7 FT	130.7 FT
FRONT YARD SETBACK (KANSAS RD)	60 FT	78.7 FT	60 FT	60 FT
MIN. REAR YARD SETBACK	35 FT	222.0 FT	169.3 FT	169.3 FT
MIN. SIDE YARD SETBACK	20 FT	N/A	N/A	N/A
MIN. MOTOR FUEL HOSE SETBACK	50 FT	N/A	N/A	N/A
MAX. BUILDING COVERAGE	35 %	3.8%	13.3%	67.3%
MAX. IMPERVIOUS SURFACE COVERAGE	75%	57.1%	67.3%	67.3%
MAX. BUILDING HEIGHT	35 FT	22 FT	22 FT	33 FT

OFF STREET PARKING	REQUIRED	EXISTING	PROPOSED
PARKING LOT USABLE AREA	450 SF PER SPACE	596 SF / SPACE	489 SF / SPACE
MIN. STALL SIZE	9.5 FT X 18.5 FT	10 FT X 18 FT (E)	10 FT X 18.5 FT
MIN. AISLE WIDTH	22 FT	24.0 FT	25.0 FT
MIN. ACCESS DRIVE WIDTH	18 FT	20.0 FT	18.0 FT
PARKING TO BUILDING	10 FT	9.9 FT (E)	10.0 FT
PARKING TO STREET PAVEMENT	20 FT	19.75 FT (MAPLE) (E)	25.7 FT (EASTON)
MIN. ULTIMATE RIGHT OF WAY ACCESS SETBACK	15 FT	EASTON RD 10.7 FT (E) MAPLE AVE 17.1 FT KANSAS RD 39.1 FT	EASTON RD 8.5 FT (V) MAPLE AVE 45.9 FT KANSAS RD 23 FT
MIN. PROPERTY LINES LIKE USES PARKING SETBACK	10 FT	42.2 FT	0 FT (V)
STREET PARKING BUFFER (CORRIDOR OVERLAY DISTRICT)	15 FT	EASTON RD 10.7 FT (E) MAPLE AVE 17.1 FT KANSAS RD 39.1 FT	EASTON RD 8.5 FT (V) MAPLE AVE 45.9 FT KANSAS RD 25 FT

LOADING AREA	REQUIRED	PROPOSED
1 (14x55)	1 SPACE	1 SPACE (14x75)

PARKING CALCULATIONS	REQUIRED	PROPOSED
LAND USE: CONVENIENCE STORE	29 SPACES (2,450 SF SALES FLOOR AREA)	50 SPACES

(E) EXISTING NON CONFORMITY  
(V) VARIANCE RECEIVED  
\* CALCULATED TO THE ULTIMATE R.O.W.

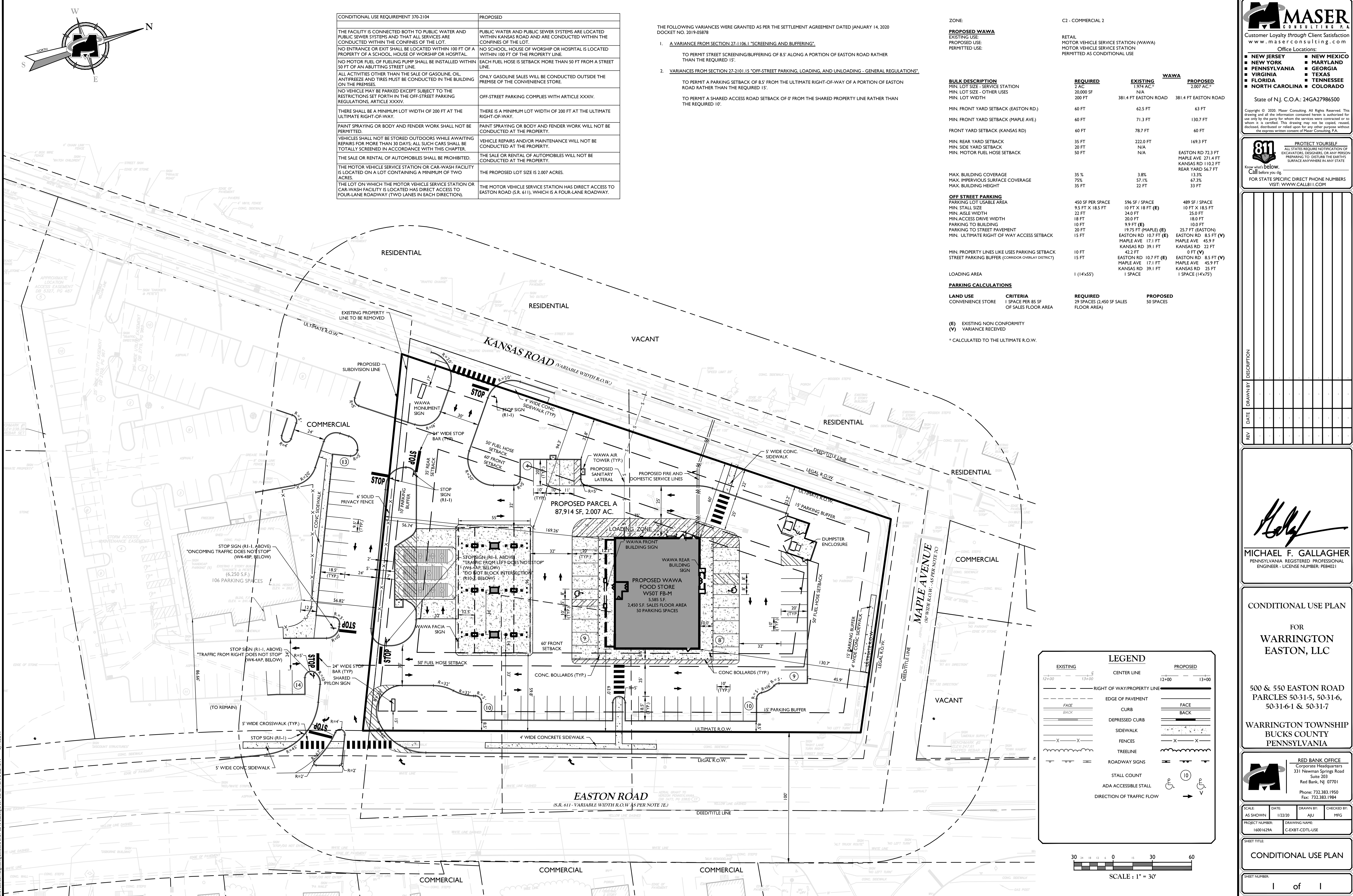

**LEGEND**

EXISTING	CENTER LINE	PROPOSED
[Symbol]	[Symbol]	[Symbol]
[Symbol]	[Symbol]	[Symbol]
[Symbol]	[Symbol]	[Symbol]
[Symbol]	[Symbol]	[Symbol]
[Symbol]	[Symbol]	[Symbol]
[Symbol]	[Symbol]	[Symbol]
[Symbol]	[Symbol]	[Symbol]
[Symbol]	[Symbol]	[Symbol]
[Symbol]	[Symbol]	[Symbol]
[Symbol]	[Symbol]	[Symbol]
[Symbol]	[Symbol]	[Symbol]
[Symbol]	[Symbol]	[Symbol]
[Symbol]	[Symbol]	[Symbol]
[Symbol]	[Symbol]	[Symbol]
[Symbol]	[Symbol]	[Symbol]

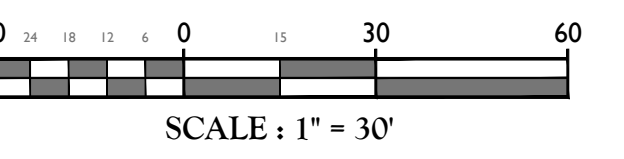

**MASER CONSULTING, P.A.**  
Customer Loyalty through Client Satisfaction  
www.masercsll.com  
Office Locations:  
NEW JERSEY, NEW YORK, PENNSYLVANIA, VIRGINIA, FLORIDA, NORTH CAROLINA  
NEW MEXICO, MARYLAND, GEORGIA, TEXAS, TENNESSEE, COLORADO  
State of NJ, C.O.A.: 24GA27966500  
Copyright © 2020, Maser Consulting. All Rights Reserved. This drawing and all the information contained herein is authorized for use only by the party for whom the services were contracted or to whom it is certified. This drawing may not be copied, re-used, disclosed, distributed or relied upon for any other purpose without the express written consent of Maser Consulting, P.A.  
PROTECT YOURSELF  
ALL STATES REQUIRE NOTIFICATION OF EXCAVATORS, DESIGNERS, OR ANY PERSON PREPARING TO DISTURB THE EARTH'S SURFACE ANYWHERE IN ANY STATE  
Know what's below.  
Call before you dig.  
FOR STATE SPECIFIC DIRECT PHONE NUMBERS VISIT: WWW.CALL811.COM

REV.	DATE	DRAWN BY	DESCRIPTION

*Michael F. Gallagher*  
**MICHAEL F. GALLAGHER**  
PENNSYLVANIA REGISTERED PROFESSIONAL ENGINEER - LICENSE NUMBER: PE84021

CONDITIONAL USE PLAN  
FOR  
**WARRINGTON EASTON, LLC**  
500 & 550 EASTON ROAD  
PARCELS 50-31-5, 50-31-6, 50-31-6-1 & 50-31-7  
WARRINGTON TOWNSHIP  
BUCKS COUNTY  
PENNSYLVANIA

**RED BANK OFFICE**  
Corporate Headquarters  
331 Newnam Springs Road  
Suite 203  
Red Bank, NJ 07701  
Phone: 732.383.1950  
Fax: 732.383.1984

SCALE:	DATE:	DRAWN BY:	CHECKED BY:
AS SHOWN	1/22/20	AJU	MPG
PROJECT NUMBER:	DRAWING NAME:		
16001629A	C-EXBT-CDTL-USE		

CONDITIONAL USE PLAN  
SHEET NUMBER: | of |

NOTE: DO NOT SCALE DRAWINGS FOR CONSTRUCTION.